

# FLOOR PLANS

Novotel Sydney Parramatta offers eleven versatile meeting and event spaces ranging from the intimate Boardroom to the Lennox Ballroom - the largest pillar-less ballroom in Western Sydney. Each function room features the latest in audio visual equipment and opens out to a bright, sunlit atrium that is ideal for pre-function gatherings, meeting breaks, cocktail events and exhibitions.



\*Room layouts not to scale

# FLOOR PLANS

## GROUND FLOOR

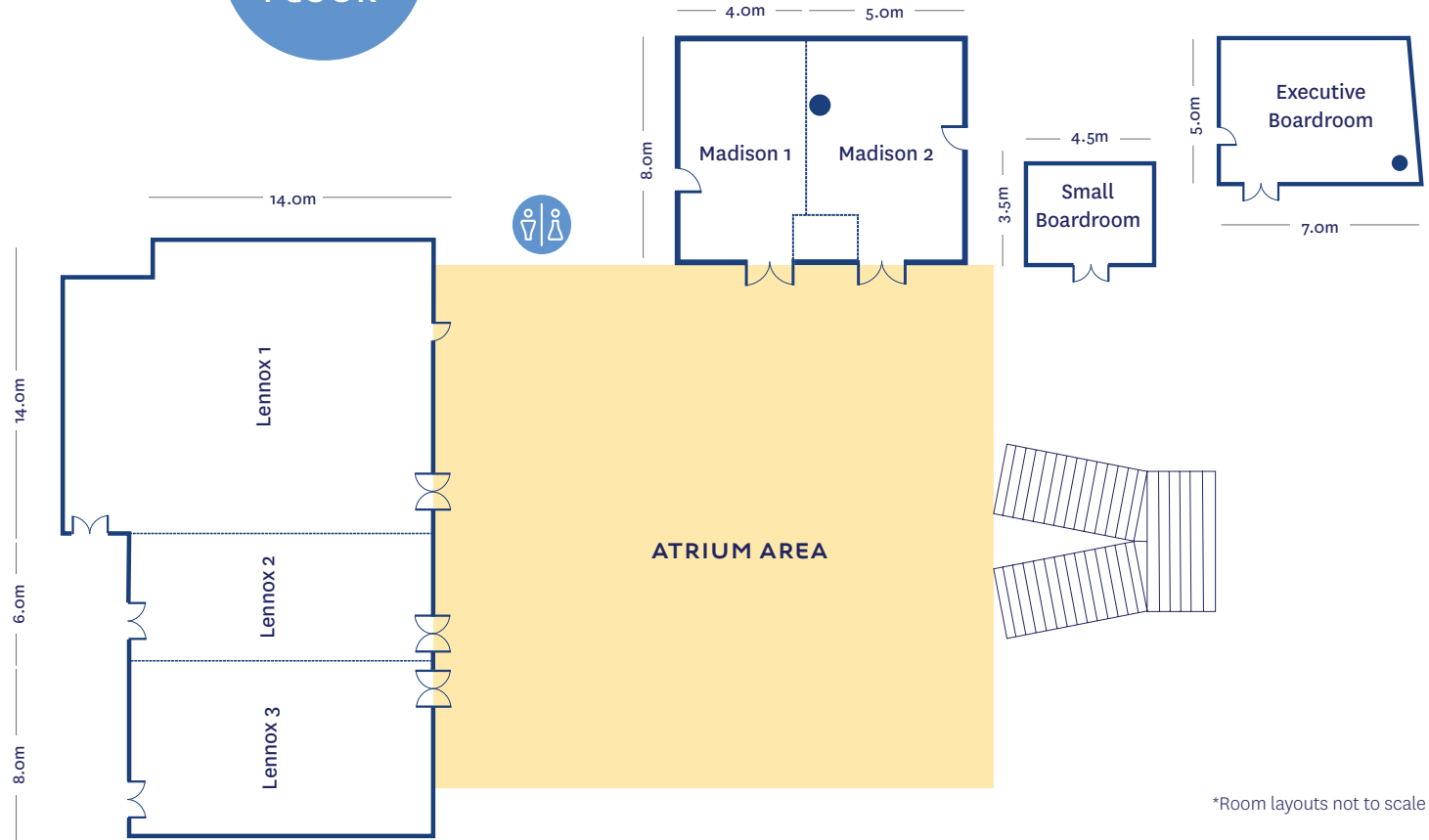

# CAPACITY

## CONFERENCE ROOM CAPACITIES



| ROOM NAME           | Height (m) | Area (m <sup>2</sup> ) | Theatre | Boardroom | U-Shape | Classroom | Cocktail | Cabaret | Banquet | Banquet Dancefloor |
|---------------------|------------|------------------------|---------|-----------|---------|-----------|----------|---------|---------|--------------------|
| <b>GROUND FLOOR</b> |            |                        |         |           |         |           |          |         |         |                    |
| Lennox Ballroom     | 3.5        | 392                    | 550#    | -         | -       | 258#      | 550#     | 264#    | 330#    | 300*               |
| Lennox One          |            | 196                    | 280#    | -         | 48#     | 150#      | 280#     | 120#    | 150*    | 140*               |
| Lennox Two          |            | 84                     | 88#     | 36        | 36      | 42        | 90       | 40      | 60      | 40*                |
| Lennox Three        |            | 112                    | 140     | 36        | 39      | 60        | 140      | 64      | 80      | 70*                |
| Lennox 1 & 2        |            | 280                    | 370#    | -         | -       | 210#      | 370#     | 176#    | 220#    | 180*               |
| Lennox 2 & 3        |            | 196                    | 240     | -         | 54      | 108       | 240      | 128     | 160     | 130*               |
| Madison 1           | 2.4        | 32                     | 50      | 12        | 15      | 21        | 50       | 16      | 20      | -                  |
| Madison 2           |            | 32                     | 50      | 12        | 15      | 21        | 50       | 16      | 20      | -                  |
| Madison 1 & 2       |            | 80                     | 104     | -         | -       | 42        | 100      | 40      | 50      | 40*                |
| Exec Boardroom      |            | 35                     | -       | 16        | -       | -         | -        | -       | -       | -                  |
| Small Boardroom     |            | 15                     | -       | 6         | -       | -         | -        | -       | -       | -                  |
| <b>LEVEL ONE</b>    |            |                        |         |           |         |           |          |         |         |                    |
| Linden              | 2.5        | 115                    | 103     | 24        | 36      | 60        | 100      | 56      | 70      | 60*                |
| Avalon              |            | 66                     | 56      | 24        | 21      | 30        | 50       | 32      | 40      | -                  |
| Jarrah              |            | 66                     | 56      | 24        | 21      | 30        | 50       | 32      | 40      | -                  |
| Carlisle            |            | 35                     | 34      | 18        | 15      | 24        | 35       | 24      | 30      | -                  |

# with stage  
\* with stage & dancefloor